



GLOBAL SURVEYORS

[Specialized in Accurate and Modern Topographical Surveying Including Road, Pipeline, Waterways Alignment, Bathymetric, Layout, Land Use and Geographical Information System Applications]

Ref. No : *GS/PRE/BAPL/21/01*

Date : *28/08/21*

SKETCH PLAN SHOWING THE PLOT FORMING AREA 27.753 KANTHA OF LAND OF M/S JUPITER REAL ESTATE. INSIDE ANDAL AEROTROPOLIS, MOUZA- TAMLA, PS ANDAL, DIST- PASCHIM BURDWAN, WEST BENGAL AS SHOWN WITH RED BORDERED THUS-

LOCATION OF PLOT- ON APPROACH ROAD OF AIRPORT FROM NH-2 AND ON NORTH SIDE OF NARAYANA SCHOOL INSIDE AEROTROPOLIS, ANDAL

DEVELOPER OF PLOT- M/S JUPITER REAL ESTATE
DURGAPUR, DIST- PASCHIM BURDWAN, WEST BENGAL

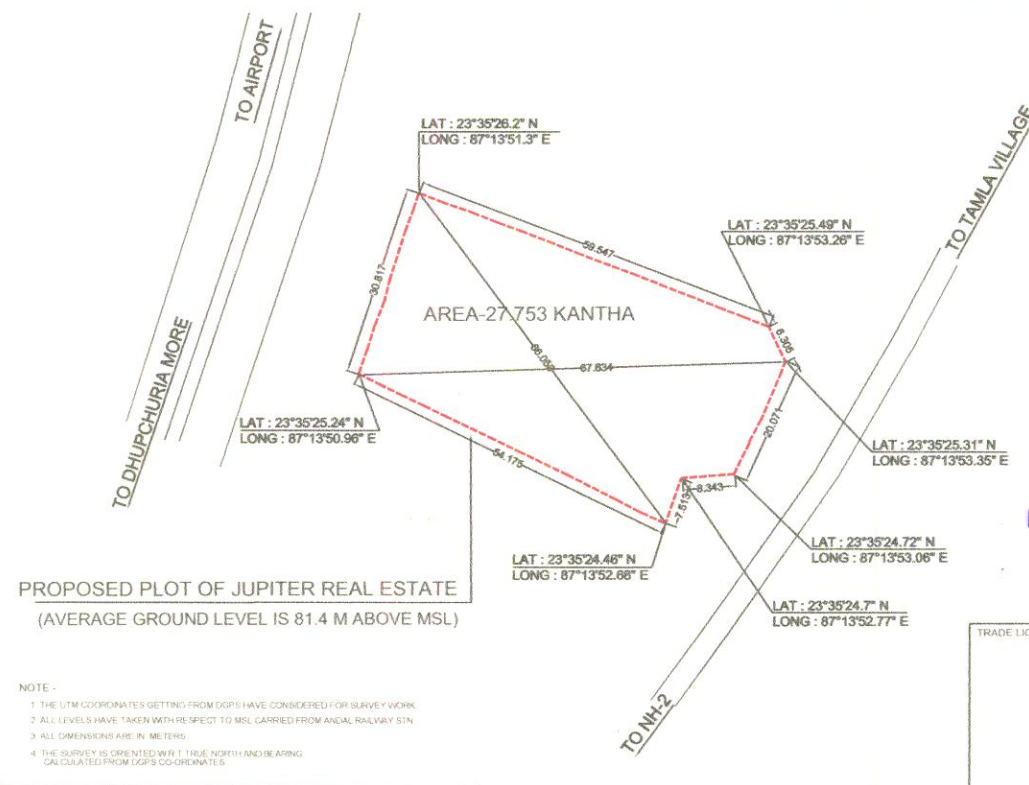
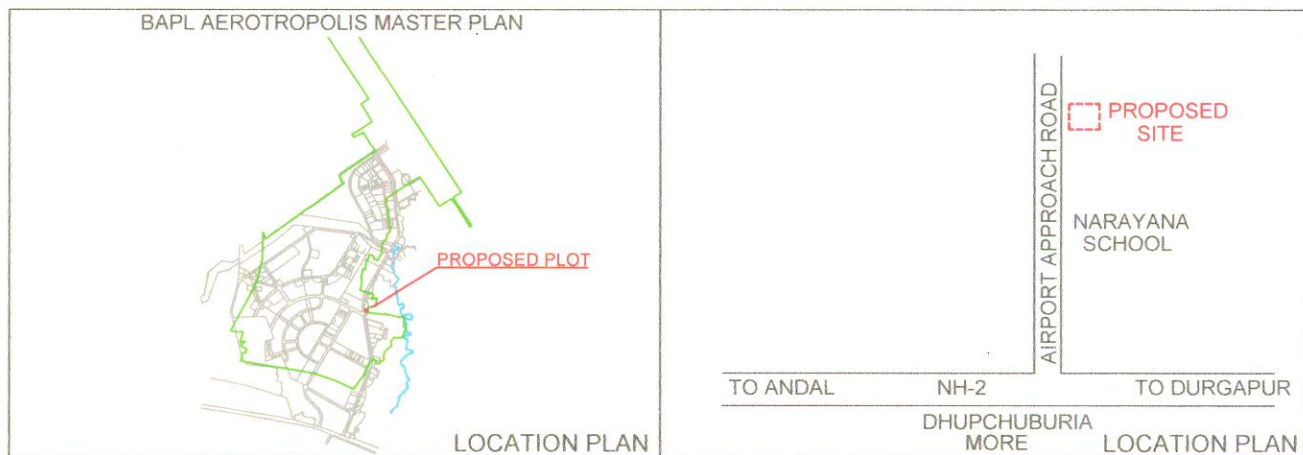

Das
GLOBAL SURVEYORS
"PUSPANJALI" SEARSOLE BABU PARA
P.O.-SEARSOLE, RAJBARI, P.S.-RANIGANJ, PIN-713358
DIST.- PASCHIM BARDHAMAN (W.B.)

TRADE LICENSE NO- 02034Y21000222 UNDER
ASANSOL MUNICIPAL CORPORATION
Das
SURVEYED BY
GLOBAL SURVEYORS
REGD OFFICE - SEARSOLE BANARPARA
P.O. - SEARSOLE RAJBARI
DIST. - PASCHIM BURDWAN (W.B.)
PIN - 713358
E-MAIL - info@globalsurveyors.org
www.globalsurveyors.org
ISO 9001:2015 CERTIFIED FROM